

iB-171ABB

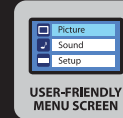

Technical Specifications

1. Display Size/Type	17" Widescreen Active Matrix TFT LCD	20. Input Voltage	AC 100~240V, 50/60Hz Autodetect
2. Resolution	1440 x 900 (WXGA+)	21. Power Consumption	32W Maximum
3. Aspect Ratio	16:10	22. Operating Temperature	5°C~35°C / 41°F~95°F
4. Pixel Pitch	0.255(H)mm x 0.255(V)mm	23. Humidity	10%~85%
5. Brightness	250cd/m ²	24. Net Dimensions	14.1"(W) x 15.7"(H) x 7.7"(D)
6. Response Time	5ms (Typical)	25. Net Weight	6.4 lbs.
7. Contrast Ratio	600:1 (Typical)	26. Gross Dimensions	17.1"(W) x 16.3"(H) x 5.0"(D)
8. Displayable Colors	16.2 Million	27. Gross Weight	8.6 lbs.
9. Viewing Angle (H/V)	160°/150°	28. Certifications	FCC, UL/CUL, CCC, CE, C-Tick, VCCI, CB, NEMKO/GS, MPRII, GOST, BSMI EnergyStar, Vista Basic
10. Color Temperature	9300K, 6500K, 5500K, User Mode	29. Package Contents	iB-171ABB, VGA Cable, Power Cable, User Manual CD-ROM, Quick Start Guide, Warranty Card
11. Panel Treatment	Anti-Glare Hardcoating	30. UPC Code	842651002626
12. Horizontal Frequency	24kHz - 80kHz	31. Warranty	1-Year Limited
13. Vertical Frequency	55kHz - 75kHz		
14. Video Input(s)	15-Pin D-SUB (VGA)		
15. Speakers	NA		
16. Headphone Out	NA		
17. Tilt	0°~20°		
18. Kensington Slot	Yes		
19. VESA Mounting	100mm x 100mm		

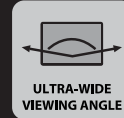